

March 21, 2010

Measurements for Arch Shapes

Arch Shapes (Arches) must be constant radius arches to be produced from measurements.

Arches with variable radius arches can only be made from templates.

5 separate dimensions are required: Width at Bottom (WAB), Width at Arch Start (WAAS), Left (L), Right (R), and Up the Middle (UTM). UTM is vertical measurement from middle of WAB through middle of WAAS to outside of arched side. If only single Width (W) is provided, we will assume $W = WAB = WAAS$. If only single Side (S) dimension is provided, we will assume $S = L = R$. For Arches without 2 sides, $L = 0$ and/or $R = 0$ and $WAB = WAAS$.

Full Arch Shapes

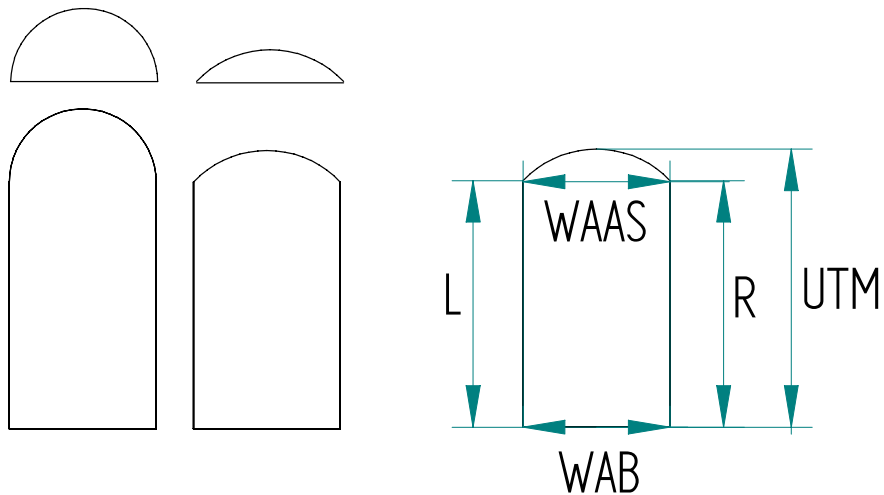

Half Arch Shapes

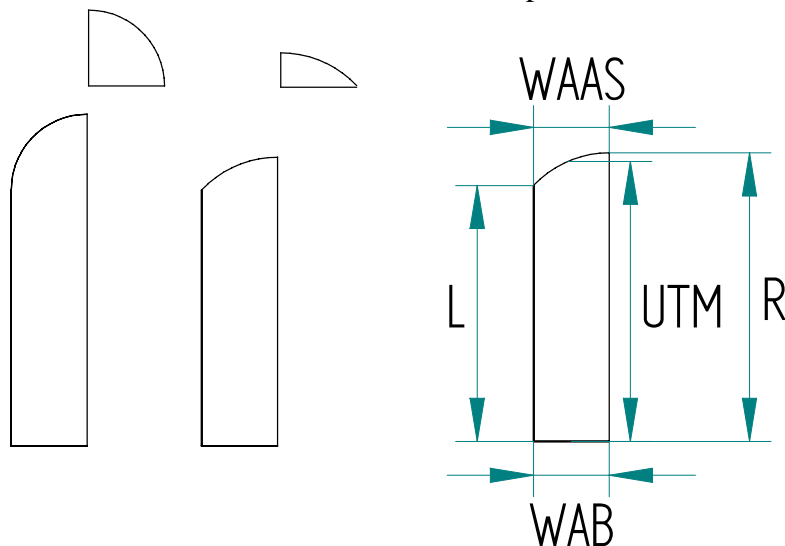

Please call us with any questions.

Orders cannot be processed unless we have correct measurements of sufficient dimensions.